

Additions Worksheet

From#: 2010-044

Information	
Name	
Address	
Phone#	
Email	

- Review all items on this page including the crawl space requirements.
- Provide a drawing /site plan on Page 2.
 - You may provide extra or larger drawings if required.
 - If you are adding an opening from the new to the old include the size and description of the support for the old roof section
 - Ledgers supporting trusses must be bolted with ½” bolts or lags
 - Window and door sizes are required on the plan
- Complete the cross section detail Page 3.
 - You may need information from your builder or material supplier
 - You cannot build your own trusses
 - Rafter framing is allowed if it meets NBC 9.23.13 “Roof and Ceiling Framing”
- Choose and check off the foundation you are using. Three foundations are shown.
 - Slab on grade foundations are not allowed unless engineered
 - All foundations must be below frost unless engineered
 - Some foundations may not be approved for large additions unless engineered
 - You may provide a drawing showing other foundations they will be reviewed to the current NBC.
 - ICF (insulated Concrete Forms) must meet the requirements in 9.15.4 “Foundation walls” for rebar, top and bottom lateral support and designs” a ICF worksheet will be provided with your plan review.
- No work can commence until you have received your plan review

Heated Crawl Space Check list (This applies to all heated spaces below a floor system)	
Space must be heated to 15 degrees year round	One heat vent for every 80 M ² (861 sq. ft.)
Walls Required to be Insulated	Insulation Requires a vapour Barrier
Must be ventilated with house system	Have a 6mil rated ground cover
Ground cover must be sealed all edges	Ground cover must be weight down e.g.: 2”Sand Cover
Unheated Crawl Space Check list (This applies to all unheated spaces below a floor system)	
Floors Required to be Insulated if heated above	Install Vapour Barrier on warm (house side) of floor
Must be ventilated with exterior vents all sides	Have a rated ground cover or concrete skim coat
Ground cover must be sealed all edges	Ground cover must be weight down e.g.: 2”Sand Cover

NOTE: All ICF Walls must be covered if there is: a source of combustion, a furnace, a water heater, over 6’ or used for storage or any other purpose. This can be drywall, Plywood, Osb or other approved material.

Cross Section and Foundation: Proposed Addition

Complete all details of the cross section

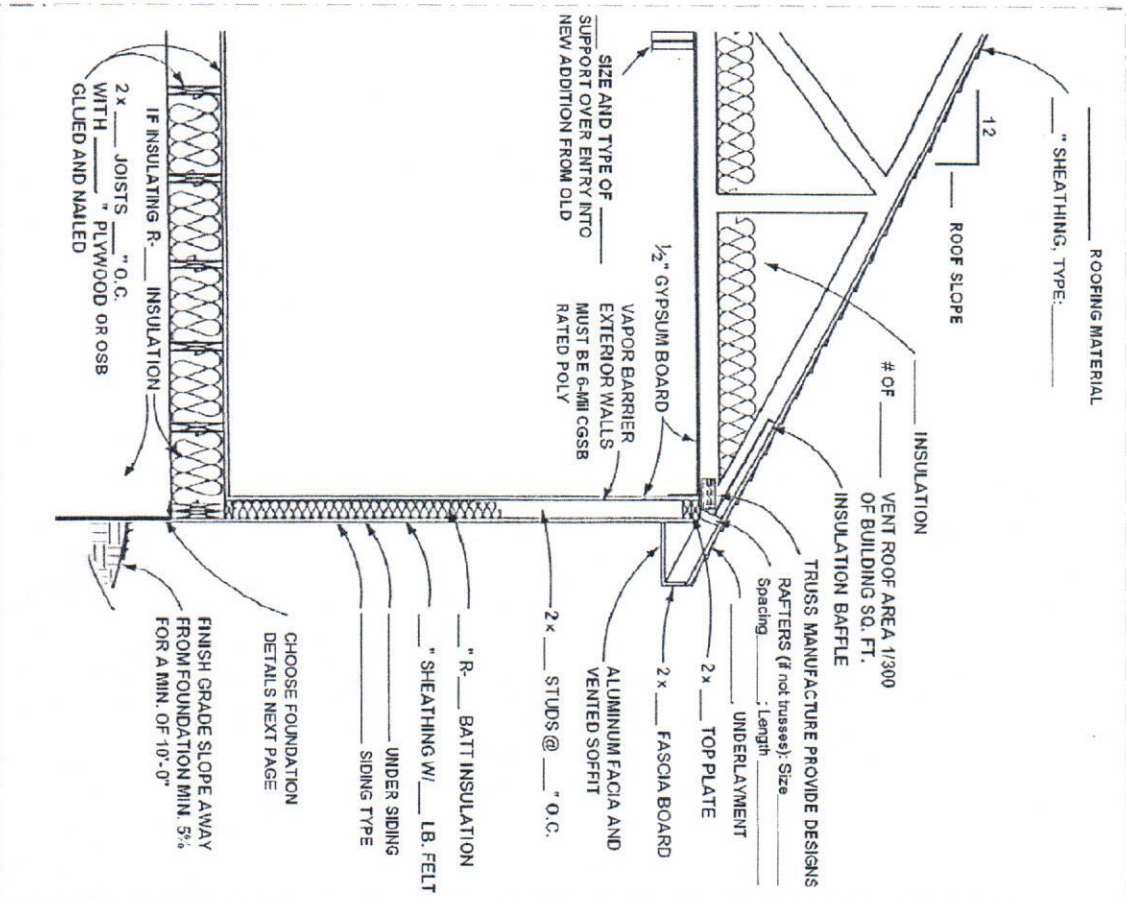

Choose a Foundation Type: (Check one below)

Fig. 2B
2x PWF Wall
3x Concrete floor or
Scribed with
approved design
20" x 8" Footing (See Fig. 1A)
Cover plate
Poly moisture
10mm x 10mm
Concrete Block

Fig. 2C
24x Concrete grade beam with 2 rows of rebar top and bottom stirrups at 16" o/c
12" x 12" Deep Piles 2-rows 15mm rebar into the pile tied to the beam, void form, piles maximum spacing 6'-6" on-center
Include sweeping tile and dampproofing
Sill plate bolted 1/2" bolts at 8' o/c

Fig. 2D
24x Concrete grade beam with 2 rows of rebar top and bottom stirrups at 16" o/c
12" x 12" Deep Piles 2-rows 15mm rebar into the pile tied to the beam, void form, piles maximum spacing 6'-6" on-center
Include sweeping tile and dampproofing
Sill plate bolted 1/2" bolts at 8' o/c

Standard Foundation: or **ICF**

Minimum 48" into ground

8" concrete wall with 2 rows of rebar top and bottom.

ICF to NBC 9.15.4 "Foundation Walls"

Standard footing 20" x 8" (or provide details) with 2 rows 10mm rebar

Include sweeping tile and dampproofing

Sill plate bolted 1/2" bolts at 8' o/c

Piles and grade beam:

24" concrete grade beam with 2 rows of rebar top and bottom stirrups at 16" o/c

12" x 12" Deep Piles 2-rows 15mm rebar into the pile tied to the beam, void form, piles maximum spacing 6'-6" on-center

Include sweeping tile and dampproofing

Sill plate bolted 1/2" bolts at 8' o/c

PWF Foundation:

Minimum 48" into ground

8" PWF wall with moisture barrier

Standard footing 20" x 8" (or provide details) with 2 rows 10mm rebar

Include Drain holes in footing

Meets S406-92 "Construction of Preserved Wood Foundations"

Approved Engineered Design

- Provide designs
- Other Approved Design
- Provide drawings

Site Plan/Plan View: Proposed Addition

Draw your proposed addition with all dimensions to property lines and to any buildings on the lot. The size of the new and the existing home.

